

Advantages

- Long life according to EUROBAT Classification
- Up to 1500 deep discharge cycles
- High discharge performance
- High gas recombination efficiency
- Maximum charge efficiency
- GEL state electrolyte prevents leakage and layering
- Low resistance PVC-SiO₂ micro-porous separator ensure Low self-discharge rate
- Easy installation vertical or horizontal

Application

- Telecommunication
- Power system
- Energy storage
- UPS
- Emergency power

Standards

- IEC 60896-21/22: 2004
- IEC61427-2005
- DIN43539-T5 1984
- DIN40742:1999
- Eurobat guide
- installation compliant with EN50272-2

Drawing

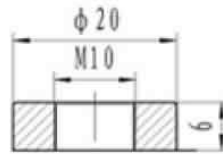
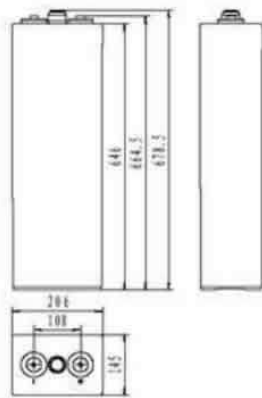

GFM-28

Specification

Battery Model	6 OPzV 600			
Designed Life (Year)	18			
Capacity(Ah/25°C)	10HR(60A,1.80V)	5HR(102A,1.80V)	3HR(150A,1.80V)	1HR(300A,1.80V)
	600	510	450	300
Dimensions (mm)	Length	Width	Height	Total Height
	145	206	646	678.5
Approx. Weight (kg)	45.7			
Internal Resistance (mΩ)	0.45			
Maximum Discharge Current(A/3 Sec.)	3496			
Self Discharge(25°C)	≤3% per months			
Charge Voltage(25°C)	Cycle use		Float use	
	2.35V(-3.5mV/°C), max charge current:120A		2.25V(-3.5mV/°C)	



Discharge Data

Constant current discharge data (25°C, A)																		
End voltage (V/cell)	min					h												
	5	10	15	20	30	1	2	3	5	6	8	10	20	24	48	100	120	240
1.65	803	723	668	613	504	346	226.0	176.6	121.6	103.0	79.6	67.8	35.5	30.50	16.10	7.78	6.54	3.39
1.70	769	670	623	578	483	330	214.0	167.2	115.0	97.2	76.4	65.4	34.7	29.90	15.98	7.70	6.51	3.38
1.75	710	632	583	538	468	316	202.0	158.4	109.0	93.6	73.4	63.0	33.0	28.80	15.78	7.64	6.48	3.36
1.80	665	597	547	499	426	300	190.8	150.0	102.0	87.2	70.6	60.0	32.2	27.67	15.60	7.57	6.45	3.34
1.85	617	541	500	453	400	286	181	142.0	97.8	84.2	66.8	56.8	31.3	26.8	15.38	7.42	6.42	3.33

Constant power discharge data (25°C, W/cell)																		
End voltage (V/cell)	min					h												
	5	10	15	20	30	1	2	3	5	6	8	10	20	24	48	100	120	240
1.65	1556	1433	1239	1151	1000	705.7	485.7	362.9	241.4	204.3	164.3	132.4	70.4	61.20	32.50	15.70	13.10	6.80
1.70	1409	1300	1147	1054	943	684.3	458.6	345.7	232.9	197.1	158.6	130.9	69.0	59.60	32.00	15.40	13.02	6.77
1.75	1289	1199	1069	970	857	670.0	428.6	331.4	227.1	191.4	154.3	126.0	68.0	57.57	31.60	15.27	12.97	6.71
1.80	1190	1086	963	881	770	611.4	408.6	312.9	211.4	178.6	148.6	123.0	66.7	55.50	31.20	15.14	12.90	6.67
1.85	1096	949	864	784	684	555.7	381.4	287.1	192.9	170.0	137.9	116.1	64.6	53.83	30.70	15.00	12.86	6.63

Performance Curve:

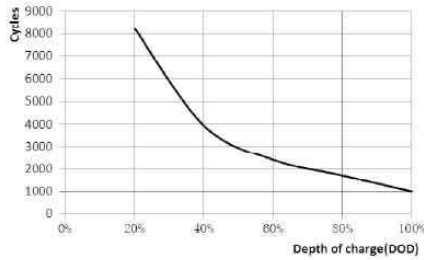

Cycle life Vs discharge depth

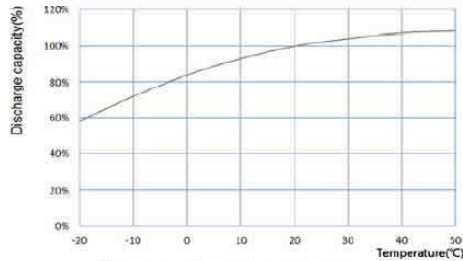

Temperature Vs capacity

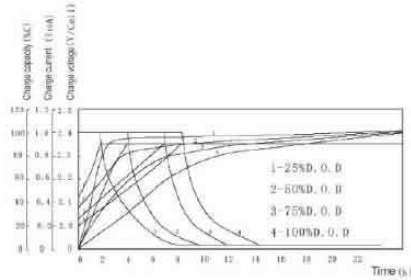

Charge vs discharge depth

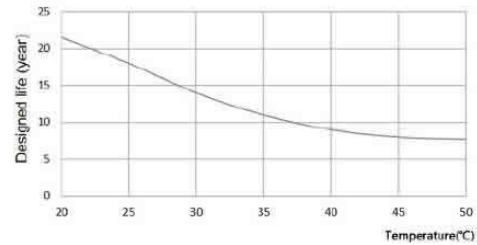

Designed life Vs temperature

नेपालभर जुनसुकै स्थानबाट जानकारीका लागि सिधा सम्पर्क गर्न सक्नुहुनेछ ।

सम्पर्क

नेपाल पावर सोलुसन प्रा.लि.

हेटौडा-२, पल्पसरोड
सम्पर्क नं.:
०५७-५२६६०६
९८५५०७२५७८
९८५५०६७७६०
९८४५३९९८८९

सानेपा, ललितपुर
सम्पर्क नं.:
०१-२२९९७६६, ५५३००९८
९८५५०६७७६०, ९८५५०७१२९४
९८६६८९३०५०, ९८६६८९३०५१

शाखा कार्यालय:

नेपालभर जुनसुकै स्थानबाट जानकारीका लागि सिधा सम्पर्क गर्न सक्नुहुनेछ ।

सम्पर्क

नेपाल पावर सोलुसन प्रा.लि.

हेटौडा-२, पल्पसरोड
सम्पर्क नं.:
०५७-५२६६०६
९८५५०७२५७८
९८५५०६७७६०
९८४५३९९८८९

सानेपा, ललितपुर
सम्पर्क नं.:
०१-२२९९७६६, ५५३००९८
९८५५०६७७६०, ९८५५०७१२९४
९८६६८९३०५०, ९८६६८९३०५१

शाखा कार्यालय: